

# ANALYTIC SYSTEMS

Power Conversion Solutions

## AC POWER SUPPLIES

### MODEL PWS1000 Series

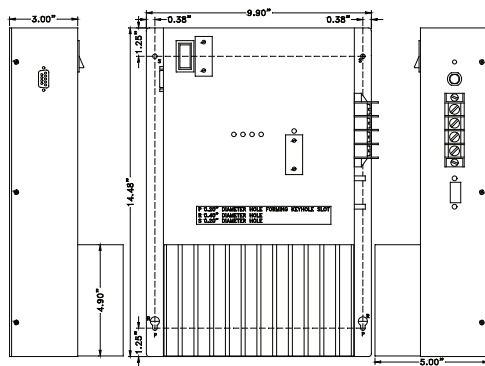

### Description

The PWS1000 Series of power supplies provides 12, 24 or 48 Volts DC at 1000 Watts of continuous power from a 110 or 220 Volt AC source.

Analytic Systems' power supplies use Switchmode technology with powerful IGBT switching transistors for reliability and efficiency with minimum size. Circuit innovations reduce output ripple to levels previously available only from bulky and inefficient linear power supplies. Reliability features include an input fuse, thermal shutdown, current limiting and output short circuit protection with automatic recovery. An Output Over voltage Crowbar circuit protects any powered devices from excessive voltage in the event of a failure of the unit.

The newly updated single-board PWS1000 is ultra-quiet and features the latest generation of current mode PWM control. Extra features include adjustable output voltage audible and visual indicators for low input voltage, low output voltage, over temperature, overload and output on. Either 110 or 220 VAC input (Field Convertible) is available. The PWS1000 also features a four contact output terminal (two positive and two negative contacts) for easy connection of devices to the supply.

### Benefits

- Ultra-Quiet
- Power sensitive electronics without interference
- Rugged and reliable to ensure years of safe and trouble free operation

### Design Features

- Adjustable output voltage
- Extremely rugged and well suited for marine and other demanding environments
- Ultra-quiet low EMI operation
- Audible & visual indicators for output overload, low input voltage, low output voltage & over-temperature
- Over-temperature shutdown
- Current limiting
- Short circuit protection
- Output overvoltage crowbar
- Dry contact output fail relay
- Remote control option
- Digital Volt/Ammeter option
- Custom output voltages available (8V to 55V)
- 19" Rackmount Available
- Three years parts and labour warranty
- Parallel output diodes available

### Applications

- Marine & other rugged environments
- Mobile Offices (TV and Radio Vans)
- Automotive / RV
- Electric Utilities and Substations
- Base Station Power (Radio & Telecommunications)
- Industrial Controls (OEM Applications)
- Field Work / Construction Sites
- Solar / Alternative Power Systems
- Emergency Power Backup (UPS)
- Security Systems
- Product Burn-in Facilities

An ISO9001 Registered Company Battery Chargers • Inverters • Power Supplies • Voltage Converters

8128 River Way, Delta B.C. V4G 1K5 Canada T. 604.946.9981 F. 604.946.9983 TF. 800.668.3884 (US/CANADA)

[www.analyticsystems.com](http://www.analyticsystems.com)

# AC POWER SUPPLIES

## MODEL PWS1000 Series

Electrical (Input)		
Nominal Vac (ip)	110	220
Actual (Vac)	90 – 130	180 - 260
Input Amps (max)	13.2(12V) 17(24/32/48V)	6.6(12V) 8.5(24/32/48V)
Input Fuse (MDA)	20A(12V) 25A (24/32/48V)	10A(12V) 15A(24/32/48V)
Input Frequency	45-65 Hz	
Noise on Input	< 50 mV	

Electrical (Output)				
Output Nominal (op)	12	24	48	72
Output Volts (DC)	13.6 ± 0.05	27.2 ± 0.05	54.4 ± 0.1	81.6± 1.5
Output Amps	60 cont. / 70 peak	40 cont. / 45 peak	20 cont. / 22.5 peak	13.3 cont. / 15 peak
Output Crowbar	16.0 ± 0.5V	32.0 ± 1.0V	63.9 ± 2.0V	96 ± 3.0V
Output Adjustment	± 1.0V			
Output Ripple & Noise	< 50 mV			
Transient Response	< 1V for 50% Surge			
Regulation (Line & Load)	< +/- 0.5%			
Duty Cycle	Peak 20% for 10 min maximum Continuous 100% for 24 hours per day			
Efficiency	> 80% @ Maximum Output			

Environment Specification	
Operating Temp. Range	-25° to +40°C @ maximum output Derate Linearly 2.5% per °C from 40°C (Optional -40°C - +55°C extra wide-temp. operation avail.)
Humidity	0 - 95% Relative Humidity (non-condensing) with optional conformal coating
Audible Noise	NONE Ødb @ 3 ft
Typical Service Life	> 10 yrs. (87,600 hrs)
Isolation	Input-Case & Input-Output 1500VDC Output-Case 500VDC (1500VDC @ 48V O/P)

Mechanical Specification	
Length	14.5 in / 36.8 cm
Width	9.9 in / 25.1 cm
Height	5.5 in / 14.0 cm
Clearance	1 inch (2.5 cm) all around
Material	Marine Grade Aluminium
Finish	Black Anodize / Powder Epoxy Coat
Fastenings	All 18-8 Stainless Steel
Weight	12 lb / 5.5 kg
Connections	Four contact output terminals
Warranty	3 years
Safety	Designed to meet CSA 22.2.107.1 & UL458

Note: Specifications are subject to change without notice.



**ANALYTIC SYSTEMS**  
Power Conversion Solutions

An ISO9001 Registered Company Battery Chargers • Inverters • Power Supplies • Voltage Converters

8128 River Way, Delta B.C. V4G 1K5 Canada T. 604.946.9981 F. 604.946.9983 TF. 800.668.3884 (US/CANADA)

[www.analyticsystems.com](http://www.analyticsystems.com)